

92-K-62 - SPEEDLINE System Data Sheet - Version V1 (24-10-23)

SPEEDLINE 92mm 'C' Stud Partition @600mm Ctrs,
with 2x Knauf 15mm Fire Panel each side,

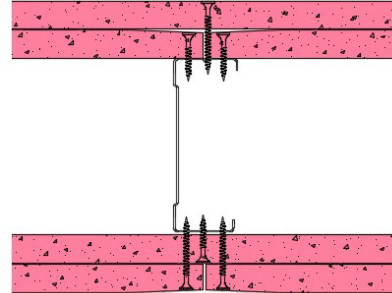

System Performance Breakdown

Fire Resistance:

BS476 Part 22:1987:

Test Ref & Date or Applied Ref & Report:

Max Height:

Thickness:

Duty Grade: BS 5234: Part 2:1992:

Sound Insulation:

120/120 Minutes (Integrity/Insulation).

BRE 288793 - BRE Report P102396-1011B

Refer to Speedline Specification Clause

154 mm. (At Base Track, Excluding Finishes)

Severe - Annexes A-F

46 R_w dB, Date Tested or Assessed Against - 70-K-57

Test Code:
H17517AA
Test Date:
08/08/2011

| Freq. Hz | R dB |
|----------|------|
| 50 | 20.8 |
| 63 | 15.3 |
| 80 | 10.7 |
| 100 | 19.6 |
| 125 | 22.5 |
| 160 | 31.4 |
| 200 | 35.4 |
| 250 | 36.9 |
| 315 | 39.1 |
| 400 | 43.1 |
| 500 | 47.7 |
| 630 | 49.4 |
| 800 | 54.1 |
| 1 000 | 55.5 |
| 1 250 | 57.5 |
| 1 600 | 60.6 |
| 2 000 | 60.7 |
| 2 500 | 51.0 |
| 3 150 | 46.6 |
| 4 000 | 49.4 |
| 5 000 | 53.1 |
| 6 300 | |
| 8 000 | |
| 10 000 | |

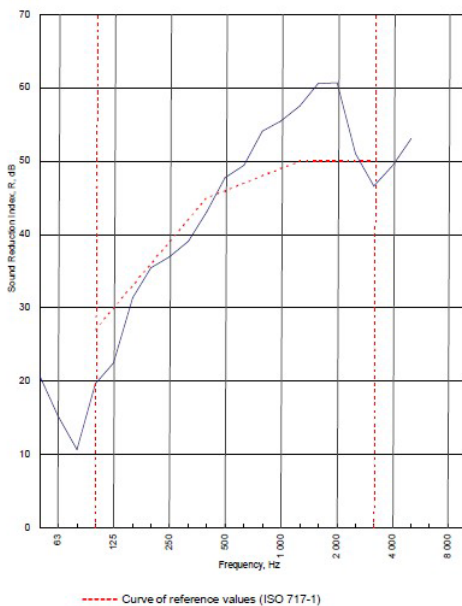

| | | | |
|---|---|--------------------------|--------------------------|
| Rating according to BS EN ISO 717-1:1997 | R_w (C;Ctr) = 46 (-3;-9) dB | | |
| Evaluation based on laboratory measurement results obtained by an engineering method: | $C_{50-150} = -6$ dB | $C_{50-500} = -5$ dB | $C_{100-500} = -2$ dB |
| | $C_{1,50-3150} = -16$ dB | $C_{1,50-4000} = -16$ dB | $C_{1,100-4000} = -9$ dB |

TESTED AT ONE OF THE UKAS ACCREDITED LABORATORIES BELOW

B.T.C (H-Ref on Graph)

B.R.E

AIRO

S.R.L

Customer: Metsec plc Hepsec Division

BTC 17517A: Page 8 of 10

